

**STR7™** Low Profile LED Strip Luminaire





The STR7™ is a low profile strip luminaire designed for installations where performance is essential and space is limited.

Typical Applications include showcase and under-cabinet lighting, cove, effect lighting, task and emergency lighting and delineation.

STR7™ is available in 6 color temperatures of white as well as Amber, Red, Green and Blue.

This Luminaire is particularly suited to installation in tight spaces where other fixtures simply will not fit. With external dimensions of only 45mm wide and 18mm high the STR7™ can be installed in the smallest of spaces.

Mounting onto almost any surface is easily achieved with number 4 screws through the integral mounting flange. It is strongly recommended that the luminaire be mounted onto a metal or concrete surface in order to sufficiently dissipate heat and ensure that the LEDs last their full rated lifetime.

**Features**

- Interior application very low profile surface mounted strip light with high power LED light source
- Anodized aluminum body available in two standard finishes
- Easy to install with #4 screws through the mounting flange
- Designed to accommodate a variety of GVA's LED Light Engines with high power LEDs
- Power/Data cable - 300mm standard length
- Cool beam, no heat (IR) or UV generated from light source
- Input voltage 24VDC
- Must be installed on metal or concrete surface for proper thermal management (Discuss your application with GVA Lighting)
- 5 Year Limited Warranty

**Options**

- Nominal lengths of 300mm, 600mm, 900mm, 1200mm, 1500mm, 1800mm, 2100mm and 2400mm.
- Clear Matte or Black Matte anodized body
- Clear or Opal lens.
- 3 x 1W LEDs or 6 x 1W LEDs per 300mm/1ft. segment
- 6 color temperatures of White diodes, plus Red, Amber, Green and Blue
- High CRI available for all colour temperatures of White LEDs
- On/Off or dimmable through DMX control. Compatible with GVA Lighting or third party DMX512-A control systems
- Analog or push dimming available with MD3 adapter



**Specification Logic**

| FAMILY | NOMINAL LENGTH | BODY COLOR       | LENS COLOR  | LED QTY. PER 300MM/1FT. | LED POWER | BEAM ANGLE | LED COLOR  | CRI**         | INPUT SIDE          | OPTIONS                        |
|--------|----------------|------------------|-------------|-------------------------|-----------|------------|------------|---------------|---------------------|--------------------------------|
| STR7   | 300            | CM - Clear Matte | CLR - Clear | 3                       | 1W        | 120°       | 2700K      | H3 - Standard | LH - Left hand feed | ND - No Dimming, On/Off        |
|        | 600            | BM - Black Matte | OPL - Opal  | 6                       |           |            | 3000K      |               |                     |                                |
|        | 900            |                  |             |                         |           |            | 3500K      |               |                     | LL - Specify custom lead cable |
|        | 1200           |                  |             |                         |           |            | 4000K      |               |                     | length in mm if not standard   |
|        | 1500           |                  |             |                         |           |            | 5000K      |               |                     | (ex. LL450, max. 300 for DMX)  |
|        | 1800           |                  |             |                         |           |            | 6500K      |               |                     |                                |
|        | 2100           |                  |             |                         |           |            | AM- Amber  |               |                     |                                |
|        | 2400           |                  |             |                         |           |            | RD - Red   |               |                     |                                |
|        |                |                  |             |                         |           |            | GR - Green |               |                     |                                |
|        |                |                  |             |                         |           |            | BL - Blue  |               |                     |                                |

Sample Logic : STR7-600-CM-CLR-6-1W-120°-5000K-H3-LH-ND

| Product Specifications            |   |   |   |                          |                |               |                |                |                |              |  |
|-----------------------------------|---|---|---|--------------------------|----------------|---------------|----------------|----------------|----------------|--------------|--|
| Nominal Length                    |   | 300   | 600   | 900                      | 1200           | 1500          | 1800           | 2100           | 2400           |              |  |
| <b>Electrical</b>                 | Rated Input Voltage   | 24VDC   |   |                          |                |               |                |                |                |              |  |
|                                   | Power Consumption DC Side (typical, LEDs driven @ 300mA)                    | 3 x 1W LEDs<br>6 x 1W LEDs  | 3.6W<br>7.2W  | 7.2W<br>14.5W            | 10.9W<br>21.7W | 14.5W<br>29W  | 18.1W<br>36.3W | 21.8W<br>43.5W | 25.4W<br>50.8W | 29W<br>58.1W |  |
|                                   | Approved Remote AC/DC Power Supplies  | Use only with listed Class 2 power supply unit, 24VDC   |   |                          |                |               |                |                |                |              |  |
|                                   | Maximum run length for end-to-end connection* (to maintain class 2 circuit) | 3 x 1W LEDs<br>6 x 1W LEDs  | 8.1m, 27ft<br>3.9m, 13ft                                  |                          |                |               |                |                |                |              |  |
|                                   | <b>Optical</b>  | Light Source  | 3 x 1W or 6 x 1W Nichia 183 series or Cree MX series LEDs |                          |                |               |                |                |                |              |  |
|                                   | CRI** (For White 183 Series LEDs)   | Standard CRI (H3): Min 75, Typ 85; High CRI (H1): Min 85, Typ 92  |   |                          |                |               |                |                |                |              |  |
|                                   | Lumens (typical for Standard CRI, 3500K LEDs @ 300mA @ 25°C ambient )***    | 6 x 1W LEDs   | 400   | 800                      | 1200           | 1600          | 2000           | 2400           | 2800           | 3200         |  |
|                                   |   | 2700K   |   |                          |                |               |                |                |                | 0.89         |  |
|                                   |   | 3000K   |   |                          |                |               |                |                |                | 0.93         |  |
|                                   | Lumens de-rating coefficient depends on color temperature***                | 3500K   |   |                          |                |               |                |                |                | 1.00         |  |
|                                   |   | 4000K   |   |                          |                |               |                |                |                | 1.00         |  |
|                                   |   | 5000K   |   |                          |                |               |                |                |                | 1.05         |  |
|                                   |   | 6500K   |   |                          |                |               |                |                |                | 1.05         |  |
|                                   | Lumens de-rating coefficient depends on CRI                                 | High CRI (H1)   |   |                          |                |               |                |                |                | 0.85         |  |
|                                   | Beam Angle (FWHM)   | 120°  |   |                          |                |               |                |                |                |              |  |
|                                   | Projected Lumen Maintenance****   | 50,000 hours @ 30°C (B50, L70)  |   |                          |                |               |                |                |                |              |  |
| <b>Control</b>                    | Interface Options   | On/Off (No Dimming)<br>DMX512-A compatible (when applicable)<br>Analog (0-10VDC) through Analog-To-DMX MD3-AD adapter<br>Push-Dim through PD-to-DMX MD3-DMX adapter |   |                          |                |               |                |                |                |              |  |
|                                   | Control Systems   | Pharos or any third party DMX512-A controllers<br>GVA's Push-Dimmer<br>Third party analog (0-10VDC) controller  |   |                          |                |               |                |                |                |              |  |
|                                   | <b>Physical</b>   | Width x Height  | mm<br>inches  | 46.5 x 17<br>1.83 x 0.67 |                |               |                |                |                |              |  |
|                                   | Actual Length   | mm<br>inches  | 328<br>12.9   | 622<br>24.48             | 915<br>36.02   | 1207<br>47.52 | 1501<br>59.1   | 1793<br>70.6   | 2085<br>82.1   | 2378<br>93.6 |  |
|                                   | Weight  | kg<br>lbs   | 0.15<br>0.33  | 0.3<br>0.66              | 0.45<br>0.99   | 0.6<br>1.32   | 0.75<br>1.65   | 0.9<br>1.98    | 1.05<br>2.31   | 1.20<br>2.64 |  |
|                                   | Housing   | Extruded aluminum body, ABS endcaps, Provista Copolymer or Acrylic lens   |   |                          |                |               |                |                |                |              |  |
|                                   | Fixture Connections   | 0.6m/2ft lead cable with stripped wires   |   |                          |                |               |                |                |                |              |  |
|                                   | Rated Operating Temperature****   | -10°C to +30°C, 14°F to 86°F  |   |                          |                |               |                |                |                |              |  |
|                                   | Environment   | Dry Locations, 0-80% humidity, non condensing   |   |                          |                |               |                |                |                |              |  |
| <b>Certification &amp; Safety</b> | Listings  | cULus, CE, RoHS   |   |                          |                |               |                |                |                |              |  |
|                                   | UL Classification   | Low Voltage LED Class 2 Luminaire   |   |                          |                |               |                |                |                |              |  |
|                                   | IEC Classification  | Surface Mount, Indoor-Use, Class III, IP40, for normal use  |   |                          |                |               |                |                |                |              |  |
|                                   | LED Class   | Class 2 LED product   |   |                          |                |               |                |                |                |              |  |



IP40



\* Values for standard drive current. Longer runs achievable with under-driven LEDs. Nominal length shown; actual length = actual fixture lengths + fixture spacings

\*\* CRI only applicable to White LEDs

\*\*\* These figures are subject to change due to further development and innovations of LED light sources.

\*\*\*\* Luminaire must be mounted on metal or concrete surface for proper thermal management

**Mechanical Drawing**

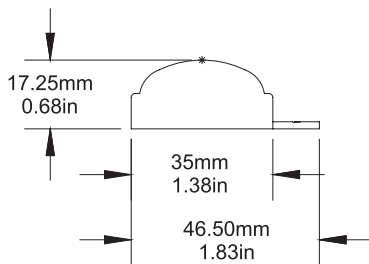
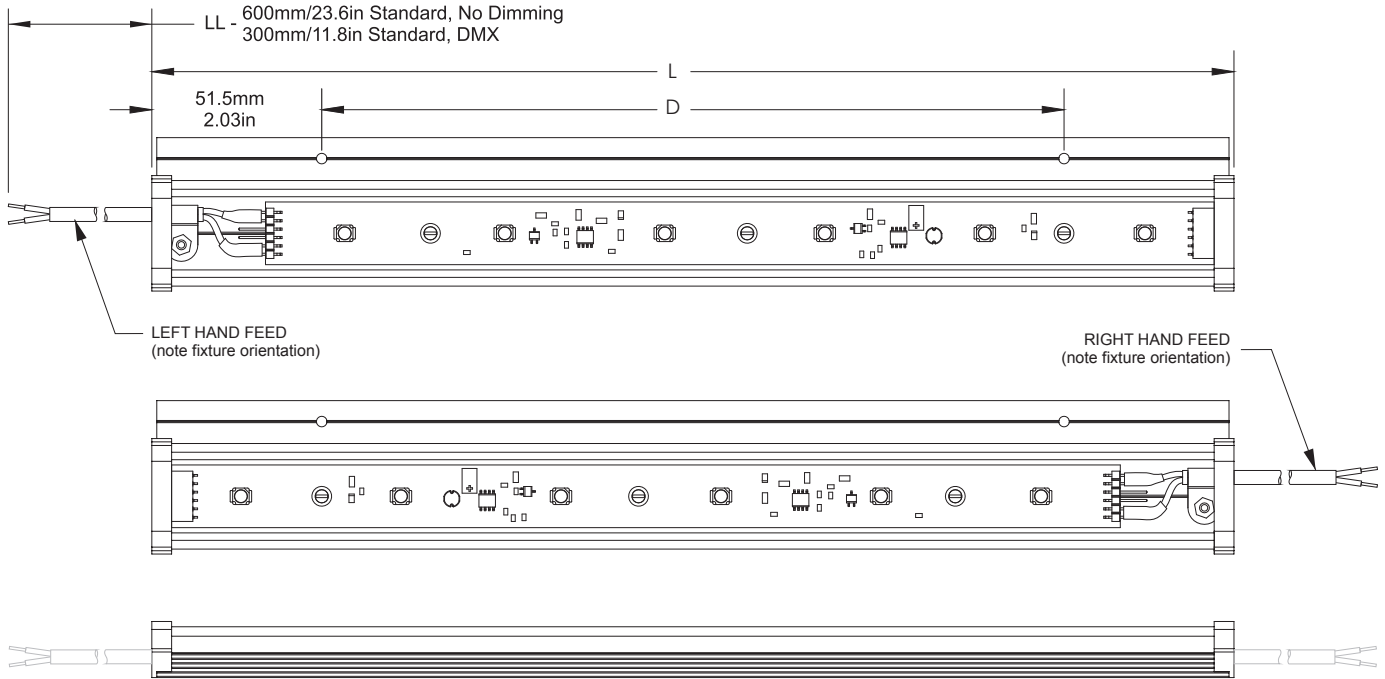

| Nominal | L    |      | D     |       |
|---------|------|------|-------|-------|
|         | mm   | in   | mm    | in    |
| 300     | 328  | 12.9 | 225   | 8.86  |
| 600     | 621  | 24.4 | 259.5 | 10.22 |
| 900     | 915  | 36.0 | 270.7 | 10.66 |
| 1200    | 1207 | 47.5 | 276   | 10.87 |
| 1500    | 1501 | 59.1 | 279.6 | 11.01 |
| 1800    | 1793 | 70.6 | 281.7 | 11.09 |
| 2100    | 2085 | 82.1 | 283.1 | 11.15 |
| 2400    | 2378 | 93.6 | 284.4 | 11.20 |

**Application Examples**



CREATING NEW BEAUTY FOR OUR HOME PLANET™



L I G H T I N G *GVA*

GVA Lighting, Inc.  
3400 Ridgeway Drive, # 14  
Mississauga, Ontario L5L 0A2, Canada  
Phone: + 1 905 569 6044  
Toll Free Phone (Canada and USA):  
1 877 GVA LIGHT or 1 877 482 5448  
Fax: + 1 905 569 9823  
Email: [info@gvalighting.com](mailto:info@gvalighting.com)

[gvalighting.com](http://gvalighting.com)