

FL™ Monochromatic
LED Projector and Flood Light



FL™ Monochromatic LED Projector and Flood Light



FL™ is a high power flood light designed to project high intensity, highly saturated light onto almost any surface. Typical applications include flood and facade lighting, building illumination, up lighting, back lighting and accent lighting.

FL™ Monochromatic Luminaires are available in On/Off or DMX Dimming versions. On/Off version maximum wattage can be factory set from 10W to 50W. DMX Version has a maximum output of 50W.

Six color temperatures of white LEDs are Available as well as Amber, Red, Green, Blue and Royal Blue LEDs. There are six beam angles available and mounting position is fully adjustable.

FL's™ cast aluminum body is optimized for thermal management and can operate at temperatures from -30°C to +50°C. The Luminaire is fully sealed and IP66 rated for outdoor use. Power input is direct, 100~240VAC.

Features

- 28 x Nichia 119 series (white) or Lumileds Rebel (color) LEDs
- Projected Lifetime 50,000hrs @ 50°C, 86°F (B50, L70)
- IP66 rated for dry, damp or wet locations
- Indoor or outdoor applications from -30°C to +50°C, -22°C to +122°F
- Die cast aluminum body designed for superior thermal management
- Optically clear, tempered, flat glass lens (no yellowing over time)
- Adjustable mounting bracket
- Cool beam, no heat (IR) from light source, no UV generated
- Line voltage power input, 100~240VAC
- 5 Year Limited Warranty

Options

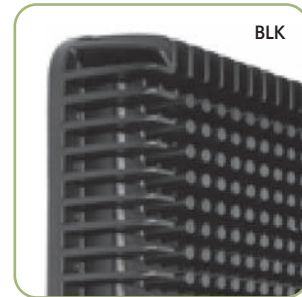
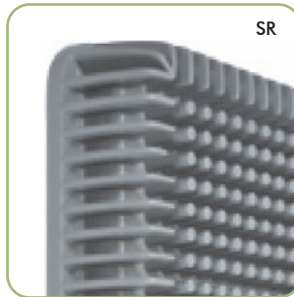
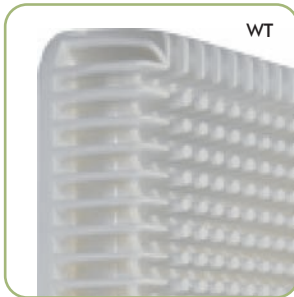

- Available in 3 body finishes; Silver Grey, Black and White
- Six Beam Patterns available: Tight Beam (8°), Narrow Beam (12°), Medium Beam (30°), Wide Beam (54°), Flood Beam (70°) and Elliptical Beam (12° x 46°)
- Six colour temperatures of White LEDs plus Amber, Red, Green, Blue and Royal Blue
- On/Off version maximum wattage can be factory set from 10W to 50W
- DMX Dimming version available



Specification Logic

FAMILY	BODY COLOR	POWER	LED COLOR	OPTICS	CONTROL
FL	WT - White SR - Silver Grey BLK - Black CUSTOM - Specify Color	50W Custom*	2700K 3000K 3500K 4000K 5000K 6500K RD - Red AM - Amber GR - Green BL - Blue RB - Royal Blue	TB - Tight Beam (8° FWHM) NB - Narrow Beam (12° FWHM) MB - Medium Beam (30° FWHM) WB - Wide Beam (54° FWHM) FB - Flood Beam (70° FWHM) EB - Elliptical Beam (12°x46° FWHM)	ND* - No Dimming, On/Off DMX - DMX Compatible

Sample Logic: **FL-BLK-50W-5000K-NB-ND**

Product Specifications			
Electrical	Rated Input Voltage		100~240VAC
	Power Consumption (AC Max.)*		50W
Optical	Light Source		28 x Nichia 119 Series (white LEDs) Lumileds Rebel (Color LEDs)
	Lumens (typical for 3500K @ 25°C ambient)**		2500
	Lumens de-rating coefficient dependant on color temperature**	2700K	0.80
		3000K	0.90
		4000K	1.10
		5000K	1.40
		6500K	1.10
Beam Angle (FWHM)		Tight 8°, Narrow 12°, Medium 30°, Wide 54°, Flood 70°, Elliptical 12°x46°	
Projected Lumen Maintenance		50,000 hours @ 50°C (B50, L70)	
Control	On/Off (No Dimming)		
	Interface DMX512-A compatible (when applicable) Analog (0-10VDC) through Analog-To-DMX MD3-AD adapter Push-Dim through PD-to-DMX MD3-DMX adapter		
	Control System e:cue or any third party DMX512-A controllers GVA Lighting, Inc. CL-DMX Controller or Push Dimmer Third party analog (0-10VDC) controller		
Physical	Width x Height x Depth	mm	245 x 349 x 51
		inches	9.64 x 13.74 x 2.01
	Weight	kg	3.38
		lbs	7.45
	Housing		Die cast aluminum body, tempered flat glass lens, optically clear with black mask
	Fixture Connections		1m (3ft) power cord with stripped wires, 1m (3ft) DMX lead cable with stripped wires (DMX version only)
	Rated Operating Temperature		-30°C to +50°C, -22°F to 122°F
Environment		Dry, damp or wet locations, 0-100% humidity	
Certification & Safety	Listings ETL/cETL, CE listing pending, RoHS		
	IEC Classification Surface Mount, indoor or outdoor use, Class I, IP66, for normal use		
	UL/CSA Classification Surface mount, for dry, wet or damp locations		
	LED Class Class 1 LED product		
 IP66 			

* No Dimming Version, custom power can be factory set from 10W to 50W.

** These figures are subject to change due to further development and innovations of LED light sources.

FL™ Monochromatic LED Projector and Flood Light

Mechanical Drawing

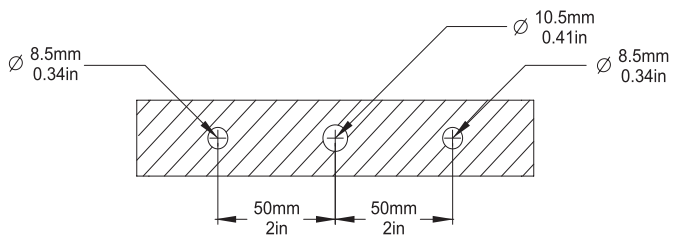
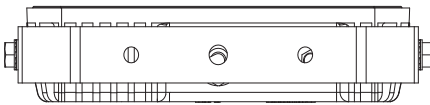
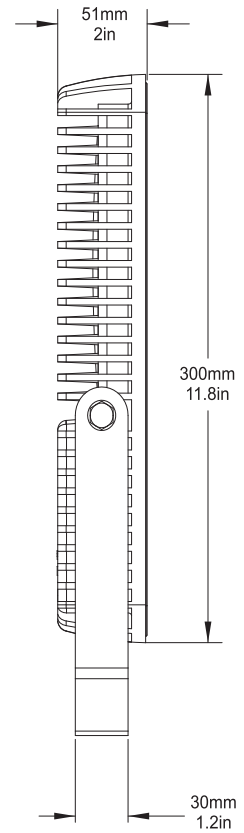
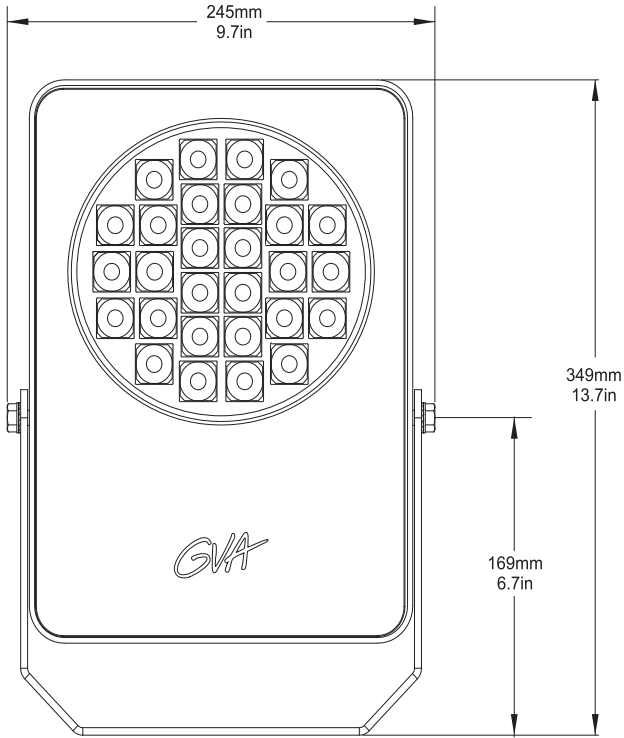

Fixture Connections, DMX Version

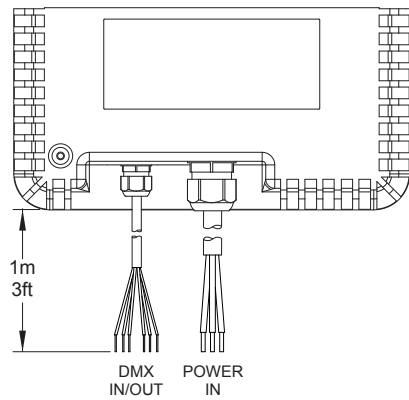

Application Example



CREATING NEW BEAUTY FOR OUR HOME PLANET™



GVA Lighting, Inc.
3400 Ridgeway Drive, # 14
Mississauga, Ontario L5L 0A2, Canada
Phone: + 1 905 569 6044
Toll Free Phone (Canada and USA):
1 877 GVA LIGHT or 1 877 482 5448
Fax: + 1 905 569 9823
Email: info@gvalighting.com

gvalighting.com